

Dimension Over Ball checking points - Det. B - I  
4:1

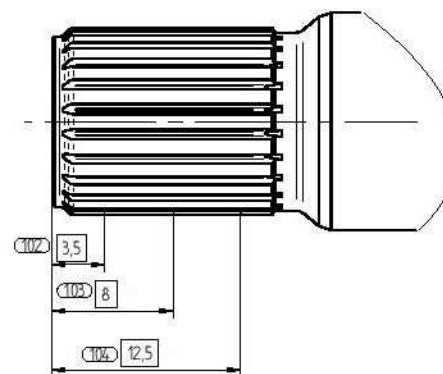

**PLATNOSŤ OD**  
**VALID FROM**  
**10/01/2018**  
**RUŠÍ A NAHRÁDZA**  
**PREDCHÁDZAJÚCE**  
**CANCEL AND REPLACE PREVIOUS**

Diameter over pin before HT	13,305 - 13,359 (Target 13,33)	(125)
Min dimension over gage pins or balls after HT (see Det. B - I)	13,32 (Target 13,35)	(126) C
Max dimension over gage pins or balls with estimated 23µm total form error after HT (See Det. B - I)	13,374 (Target 13,350) (See note 1)	(127) C

Codice Cliente / Customer Code				Codice Disegno del Cliente / Customer Design Code <b>06572814 rev.16 (C)</b>			
Gen. tol. ±0,3; angles ±1°				Rough Radii 0,3			
Stress				Roughness 3,2			
Particolare Part				Shaft - Delta 2			
Riformanti Reference				Rullato			
Codice PIN				None File Filenome			
Data Dis. / Draw				10/04/2014			
Cont. / Chk				G/9/V/2018			
Appr. / Appr				10/01/2018			
Materiale Material				Trattamento Treatment			
Pesa grezza Raw weight				Pesa finita weight			
Forma Form				207g			